

# US Series

## Wall Mount AC/DC Adaptor

### 12W Series



▲ US10/US30



▲ USY30



▲ USR30



▲ USA30



■ Please contact our sales department for safety standard of each model.

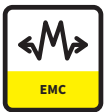

## Product Highlights

- Stability
- Compact type
- Energy efficiency
- Suit GPS, network, multimedia, audio & video equipment.

## Efficiency

- Meet : Commission Regulation (EC) No 278/2009 ( ERP 5 )& CEC 5

## Immunity

- EN55024/A1:2001

## Protection

- Short circuit protection
- Over Voltage Protection
- Over Current Protection

## Emissions

- FCC Part15 Class B
- CE CISPR 32 Class B
- VCCI Class B
- CNS13438
- GB9254/GB17625.1
- KN32 KN35

## Safety Approvals

- UL60950
- CAN/CSA C22.2 NO. 60950
- PSE
- IEC/EN60950-1
- IEC/EN61558
- CNS14336
- GB4943.1
- K60950

# Electrical Spec

## Absolute Maximum Rating

Input					
Description	Min	Typ	Max	Units	Comment
Voltage	90	100~240	264	Vac	
Frequency	47	50/60	63	Hz	

Environmental					
Description	Min	Typ	Max	Units	Comment
Operating Temperature	0	-	40	°C	Free Convection,Sea level
Storage Temperature	-20	-	65	°C	Free Convection,Sea level
Operating Humidity	5	-	95	%RH	No Condensing
Storage Humidity	5	-	95	%RH	No Condensing

# Typical model list

Input Condition	DC Output Voltage	DC Output Current	Output Voltage Precision	Ripple	Noises	Regulation		Option/Remark	
						Line	Load		
Input Voltage: 90V-264Vac Frequency: 47-63Hz	1	3.0V	2.0A	-5%~+8%	50mV	100mV	2%	10%	
	2	3.3V	2.0A	-5%~+8%	50mV	100mV	2%	10%	
	3	5.0V	2.0A	±5%	50mV	100mV	2%	10%	
	4	6.0V	1.8A	±5%	60mV	120mV	2%	10%	
	5	7.5V	1.6A	±5%	75mV	150mV	2%	10%	
	6	9.0V	1.3A	±5%	90mV	180mV	2%	10%	
	7	9.5V	1.0A	±5%	190mV	380mV	2%	10%	
	8	12.0V	1.0A	±5%	120mV	240mV	2%	10%	
	9	15.0V	0.8A	±5%	150mV	180mV	2%	10%	
	10	18.0V	0.65A	±5%	180mV	360mV	2%	10%	
	11	-	-	-	-	-	-	-	-

■ Measurement condition

1. Measurements shall be made with an oscilloscope with 20MHz bandwidth.
2. Outputs shall be bypassed at the connector with a 0.1uF ceramic disk capacitor and a 10uF electrolytic capacitor to simulate system loading.

# Mechanical Spec

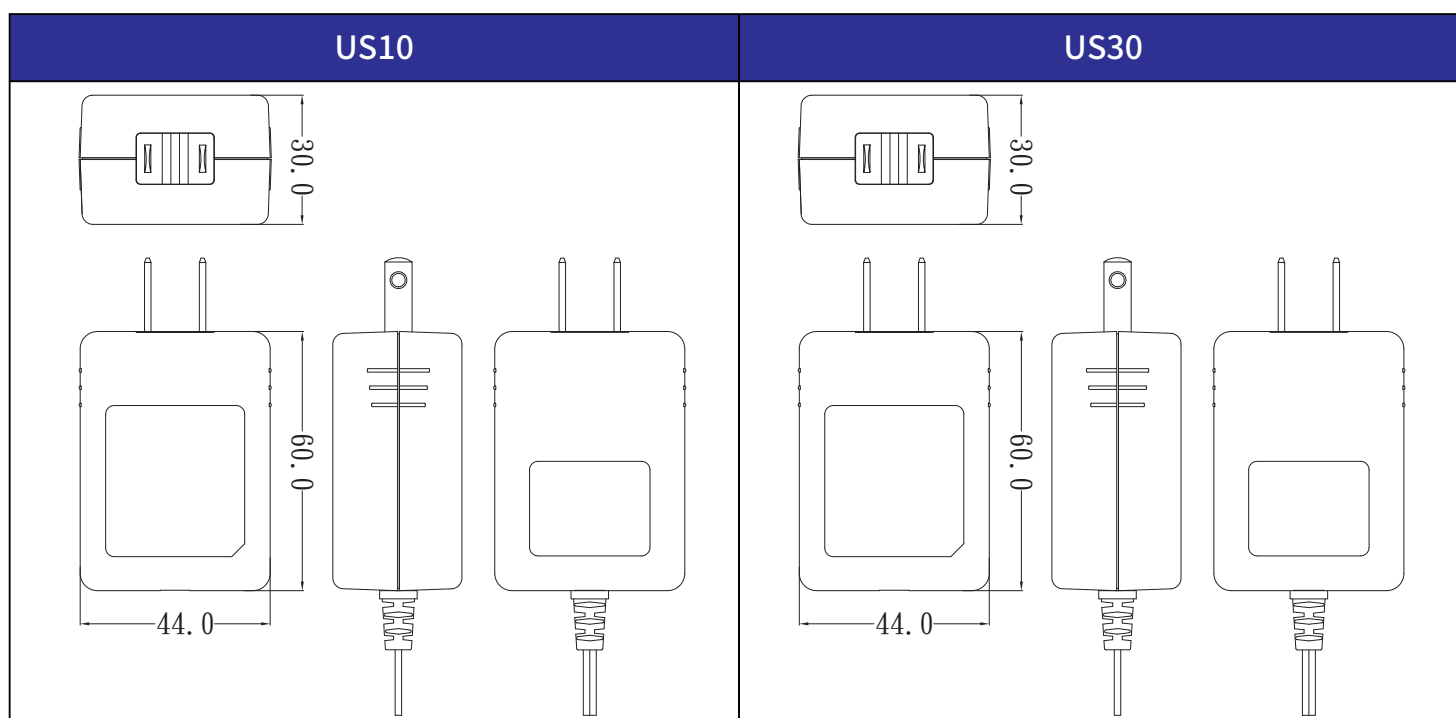

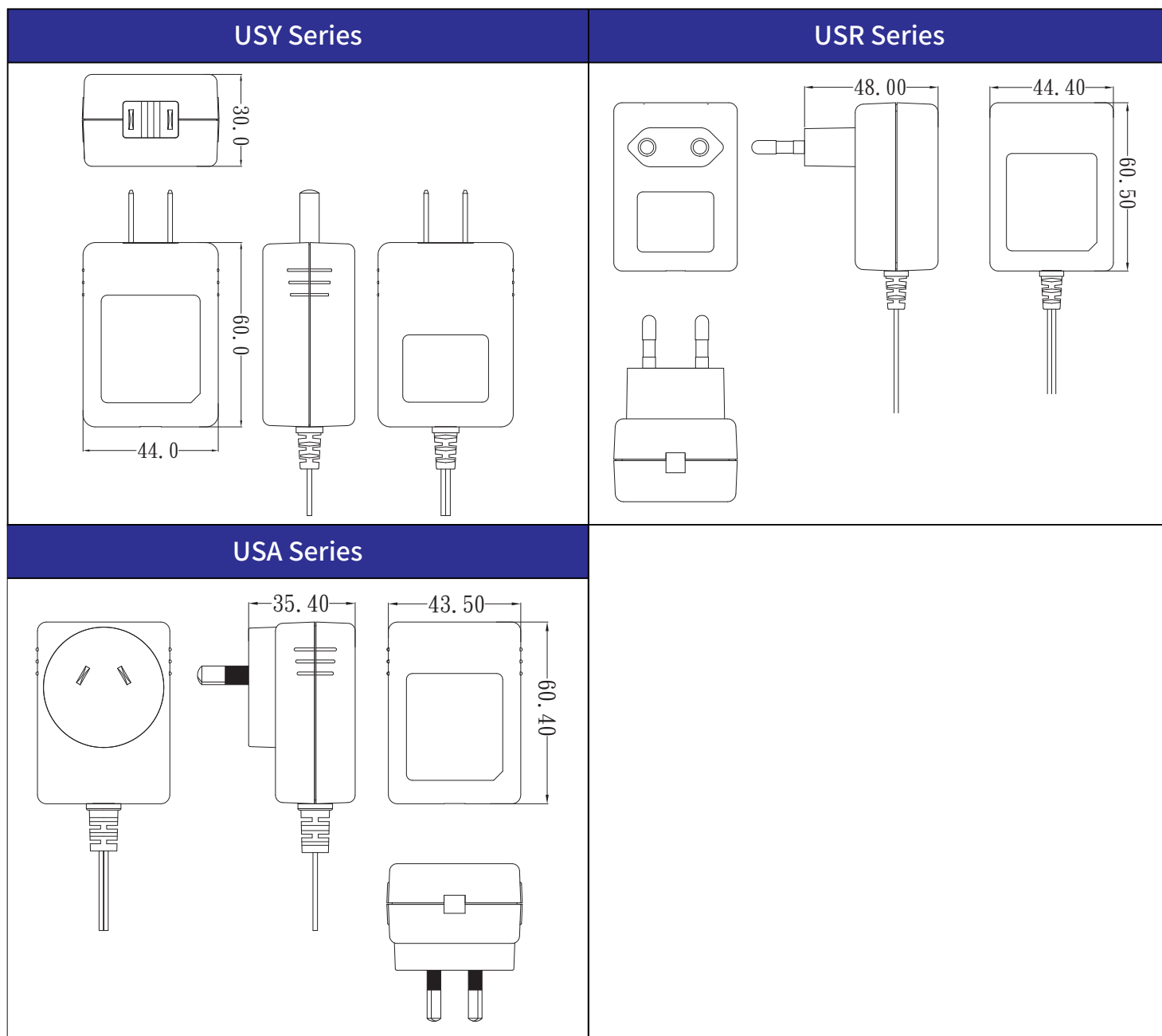

■ Please contact our sales department for details of each model ■