

# UMOAT 18W Series

Medical | Open Frame

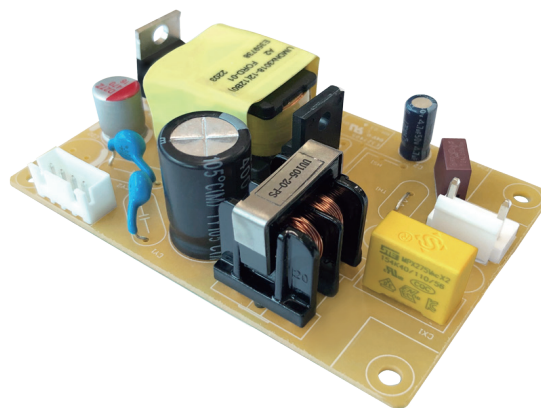

▲ UMOAT3018



For further information of UxOAT 18W series' safety standard, please contact us.

## Model Name Definition

# U x O A T 3 0 1 8

**x : Depend on Safety Standard**

- Audio / AV / IT
  - N 62368-1
  - A 60065-1
  - I 60950-1
- Medical
  - M 60601-1
- Home
  - H 61558-1
  - O 60335-1

## Product Highlights

- Stability
- Full Range Input Voltage (90Vac~264Vac)
- Suit computer device, portable HDD, small house hold equipment
- Appendix 8 of PSE : Comply with Dusty Requirement.

## Protection

- Short Circuit Protection
- Over Voltage Protection
- Over Current Protection
- Over Temperature Protection (Optional)

## Standard\*

- Audio / AV / IT  
62368-1  
60065-1  
60950-1
- Medical  
60601-1
- Home  
61558-1  
60335-1
- Complies with DEN-AN

\*UxOAT 18W series is designed to MEET all standards above.

## Efficiency

- Up to

85%

## Emissions

- FCC Part18 Class B
- CE CISPR 11 EN55011
- CE CISPR 14 EN55014-1
- FCC Part15 Class B
- CE CISPR 32 EN55032
- BS EN 55032
- BS EN55011
- BS EN55014-1

## Immunity

- EN 55035
- BS EN 55035
- EN60601-1-2
- BS EN60601-1-2
- BS EN55014-2
- EN55014-2

## Electrical Spec

Input					
Description	Min.	Typ.	Max.	Units	Comment
Voltage	90	100~240	264	Vac	
Frequency	47	50/60	63	Hz	

Environmental					
Description	Min.	Typ.	Max.	Units	Comment
Operating Temperature	0	-	50	°C	Free Convection,Sea Level
Storage Temperature	-20	-	65	°C	Free Convection,Sea Level
Operating Humidity	5	-	95	%RH	No Condensing
Storage Humidity	5	-	95	%RH	No Condensing

## Typical model list

Output Port	DC Output Voltage	DC Output Current	Output Voltage Precision	Ripple	Noise	Average Active Efficiency	Option/Remark
CN2	5.0V	3.0A	±5%	150mV	150mV	81.38%	
	9.0V	2.0A	±5%	180mV	180mV	85.0%	
	12.0V	1.5A	±5%	180mV	180mV	85.0%	
	24.0V	0.75A	±5%	240mV	480mV	85.0%	

### ■ Measurement Condition

1. Measurements shall be made with an oscilloscope with 20MHz bandwidth.
2. Outputs shall be bypassed at the connector with a 0.1uF ceramic disk capacitor and a 10uF electrolytic capacitor to simulate system loading.

Mechanical Spec

TOLERANCE: ±0.5  
Unit:mm

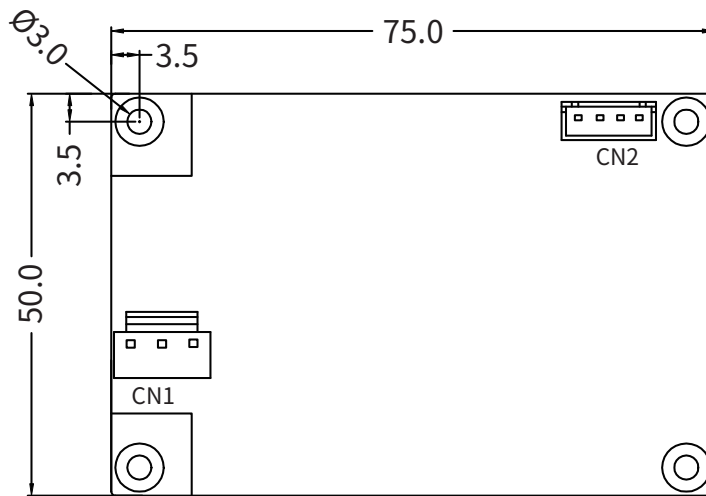

CN1

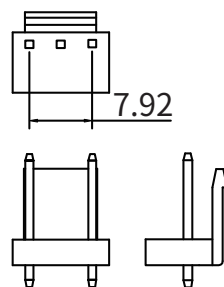

CN1

PIN NUMBER	INPUT
1	AC(L)
2	
3	AC(N)
CN1 : INPUT CONNECT MODEL NO : JSY 3PIN A3963WV-3P (THE EQUIVALENT)	

CN2

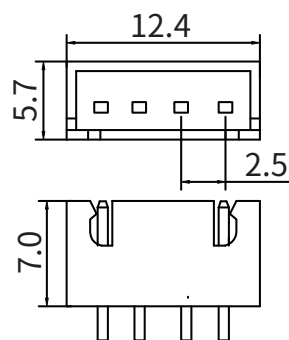

CN2

PIN NUMBER	OUTPUT
1,2	VO+
3,4	VO-
CN2 : OUTPUT CONNECT MODEL NO : JSW 4PIN A2501WV-4P P=2.5mm (THE EQUIVALENT)	

■ Please contact our sales department for details of each model ■